

Grand Door Prize Drawings
following afternoon sessions on
BOTH DAYS
at Grand Upton Hall



Be sure to save your door prize tickets!
Have them punched at the trade show
vendor booths, sign your name and deposit
into the door prize drawing box.
Drawings for two prizes will be held in the
trade show area both days during
the lunch break and after the
afternoon sessions



Michigan State
Horticultural Society

 Beverly County Printing



2018
Southwest Michigan
Horticultural
Days



February 7 & 8

Lake Michigan College
Mendel Center
Benton Harbor, MI

SPONSORED BY:



MICHIGAN STATE | **Extension**
UNIVERSITY

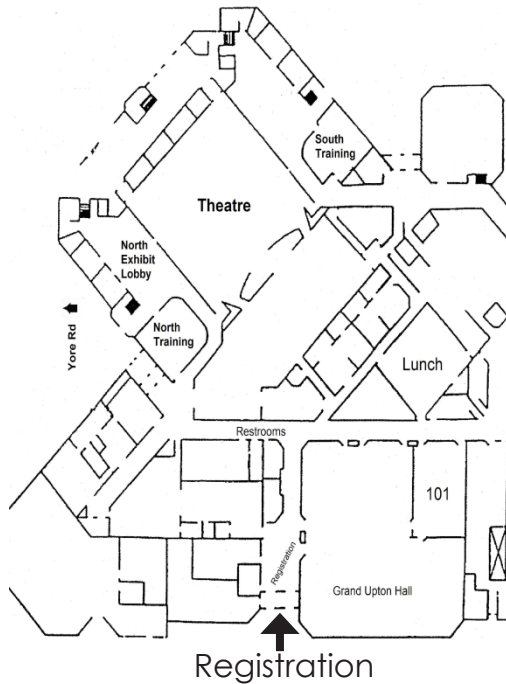

North Parking Lot

You are welcome to attend the
**Southwest Michigan
Wine Showcase**

Wednesday, February 7, 2018

4:30 p.m.

Located in the trade show area

The information given herein is supplied with the understanding that no discrimination is intended and no endorsement by MSU is implied. MSU is an affirmative-action, equal-opportunity employer. Michigan State University Extension programs and materials are open to all without regard to race, color, national origin, gender, gender identity, religion, age, height, weight, disability, political beliefs, sexual orientation, marital status, family status, or veteran status.

Southwest Michigan Horticultural Days

WEDNESDAY, FEBRUARY 7, 2018

- 8:00 Registration and Visit Exhibits
- GENERAL SESSION**
Upton 101 (3 RUP credits)
- 9:00 Changes in the Climate So Far, How Agriculture is Affected, and What Lies Ahead
- Jeff Andresen, MSU Climatology
- 10:00 H2A Worker Program
- Laurie Swanson, Great Lakes Ag Labor Services
- 10:45 Break
- 11:00 MAEAP Update - Kyle Mead, Mike Ludlum and Suzanne Forraht, Southwest Michigan Conservation Districts
- 11:15 Soil Health: What is It and How Do We Get It
- Christina Curell, MSU Extension
- 11:40 Food Safety Update - Phil Tocco, MSU Extension
- 12:00 Lunch - Visit Exhibits

AFTERNOON TREE FRUIT SESSION

Upton 101 (3 RUP credits)

- 1:30 Honeycrisp Bitter Pit: Physiology and Mitigation Strategies - Lailiang Cheng, Horticulture Section, School of Integrative Plant Science, Cornell University (Remote Presentation)
- 2:10 Cold hardiness and PGRs: New Work to Manage Issues Around Cherry Flowering and Fruit Set - Todd Einhorn, Tree Fruit Specialist, Horticulture Dept, MSU
- 2:50 Current Research to Understand and Develop Better Management of Fire Blight in Pome Fruit - Suzanne Slack, Dept of Plant, Soil and Microbial Sciences, MSU
- 3:30 The Pollination Paradox: Balancing Pest Management and Pollinator Health in Tree Fruit Crops - Jackie Albert, Dept of Entomology, MSU
- 4:00 Adjourn

AFTERNOON VEGETABLE SESSION

North Training (3 RUP credits)

- 1:30 The Pollination Paradox: Balancing Pest Management and Pollinator Health in Vegetable Crops - Jackie Albert, MSU Dept of Entomology
- 2:15 Nematode Vegetable Survey Results, Nematode Recommendations, and Intro to the New MSU Applied Nematology Lab
- Marisol Quintanilla Tornel, MSU Dept of Entomology

- 2:45 Innovative Cover Cropping Strategies for Vegetables - Zach Hayden, MSU Dept of Horticulture
- 3:30 Asiatic Garden Beetle: A New Pest for Sweet Corn, and Other Corn Root Insects
- Bruce MacKellar, MSUE Van Buren County
- 4:00 Adjourn

AFTERNOON WINE GRAPE SESSION

North Exhibit Lobby (3 RUP credits)

- 1:30 Techniques for Achieving Consistent Color Stability in Red Wines - Michael Jones, Scott Labs
- 2:30 Fruit Zone Microclimate Manipulation: Coupling and Improving Fruit Maturation
- Paolo Sabbatini, MSU Horticulture
- 3:00 "Itasca," a Newly-Released Wine Grape Variety from the University of Minnesota Breeding Program
- Matt Clark, University of Minnesota
- 3:30 Microvinification of Itasca and Other Varieties (tasting of these wines at 4:30 in the trade hall)
- Mike de Schaaf and Mike Moyer, Lake Michigan College
- 4:00 Adjourn

THURSDAY, FEBRUARY 8, 2018

MORNING MARKETING SESSION

North Training (3 RUP credits)

- 9:00 Marketing and Retention Strategies to Attract and Keep Great Farm Workers - Katie Brant, MSU Student Organic Farm, Groundswell Farm
- 10:00 The Pricing Game: What is the True Cost of What You Produce and What Do You Need to Charge? - Joaneé DeBruhl, Stone Coop Farm
- 11:00 Understanding Your Market: Growing and Selling What People Want - Ben Martin, Soil Friends Farm, Roger Miller, R&B Miller Farms, Aaron Molter, Molter Family Orchards
- 12:00 Lunch - Visit Exhibits

MORNING GRAPE SESSION

Upton 101 (3 RUP credits)

- 9:00 Sour Rot Management for Improved Fruit Quality in Pinot Gris - Thomas Todaro, MSUE Leelanau County
- 9:30 Climate Change and Grape Production in Michigan
- Gregory Jones, Linfield College, Oregon
- 10:30 Michigan Grape Society annual meeting
- 11:15 What Does the Wine Consumer in the Midwest Really Respond To?
- Dan McCole, MSU Dept of Community Sustainability
- 12:00 Lunch - Visit Exhibits

MORNING BLUEBERRY SESSION

North Exhibit Lobby (3 RUP credits)

- 9:00 Maximizing Yield in Established Blueberry Plantings
- Mark Longstroth, MSUE Van Buren County
- 9:40 Impact of IPM Training on the Success of Managing the SWD in Berry Crops
- Carlos Garcia-Salazar, MSUE Ottawa County
- 10:10 Break
- 10:30 Insect Management Update in Blueberry
- Rufus Isaacs and Steve VanTimmeren, MSU Dept of Entomology
- 11:10 Bird Management in Blueberries
- Catherine Lindell, MSUE Horticulture
- 12:00 Lunch - Visit Exhibits

AFTERNOON TREE FRUIT SESSION

North Training (2 RUP credits)

- 1:30 Expanding the Range for Establishing Samurai Wasp in Orchards and Vegetable Crops of New York State
- Peter Jentsch, Sr. Extension Associate, Cornell University
- 1:50 Latest Findings on Insect Management in Tree Fruit - Larry Gut, Professor, MSU
- 2:30 Old, New and Novel Tools for Management of the Asian Invasive Brown Marmorated Stink Bug - Peter Jentsch, Sr. Extension Associate, Cornell University

AFTERNOON BLUEBERRY SESSION

North Lobby (2 RUP credits)

- 1:30 Fertilizing Blueberries - Eric Hanson, MSU
- 2:10 Blueberry Disease Control
- Mark Longstroth, MSUE Van Buren County

AFTERNOON GRAPE SESSION

Upton 101 (2 RUP credits)

- 1:30 50 Years of Michigan Viticulture - A Retrospective - Josh VanderWeide, MSU Dept of Horticulture
- 2:00 Insect Update with Emphasis on Late-Season Pest Control - Keith Mason, MSU Dept of Entomology
- 2:30 Economic Impact of Grapes and Wine in Michigan
- Karel Bush, MI Grape and Wine Industry Council
- 3:00 Adjourn

**In the event of inclement weather,
call 269-944-1477 x205
for cancellation details**